

Type B

3 Bedroom Unit

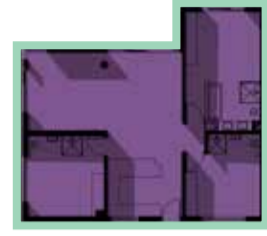

Type B Area Summary

Unit
110m²

Balconies
18.3m² / 21.6m² / 35m² / 49m²

Total
198.8m² / 199.5m² / 145m² / 159m²

- 1 Balcony
3m²
- 2 Lounge
3.9m x 3.9m
- 3 Bathroom 01
2.7m x 1m
- 4 Bedroom 01
3.8m x 3m
- 5 Kitchen
3.7m x 2.8m
- 6 Dining
3.7m x 5.2m
- 7 Balcony
3.6m x 2.9m
- 8 Covered Patio
4m x 0.9m
- 9 Master Bedroom
3.7m x 3.5m
- 10 Bathroom 02
2.7m x 2.4m
- 11 Bathroom 03
2.6m x 1m
- 12 Bedroom 03
3.7m x 3.1m



Artist's Impression

3 Bedroom Unit Floor Plan



SANDTON GATE
TERRACE